

1. Attach plastic feet to all 4 uprights
2. Attach side beams to the uprights at desired heights and secure with rubber mallet.
3. Attach top & bottom face beams at the same level as the side beams to secure the bay.
4. Attach all back beams into the bay
5. Stand dividers to the left of the bay, then insert the second and third front beam.

6. Place 1 panel for each of the first 3 levels on the right of the bay. Move the first divider up to panels, then place next panels for the first 3 levels on the left of the divider and repeat.

7. Once the first three levels of panels have been placed into the bay, place the rest of the dividers on top of the dividers that are already in the bay. Then place the rest of the face beams followed by the shelf panels into the bay.

8. Align back panel using the joining ribs to join the 2 panels. Mark drilling positions through the upright keyhole - **top, middle & bottom** on both sides. Drill and fit using the supplied M6x25 nuts, bolts & spacers. Repeat for side panels.

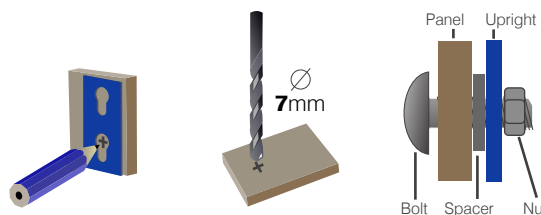

Tools Required

Rubber Mallet, Drill & Wood Drill Bit (7mm), Spanner (10mm), Flat Head Screwdriver

Safety Precaution

Two competent people wearing safety gloves, safety shoes and protective eyewear are recommended to undertake the assembly.



scan for more info